

465

California Street

San Francisco, California



7th Floor

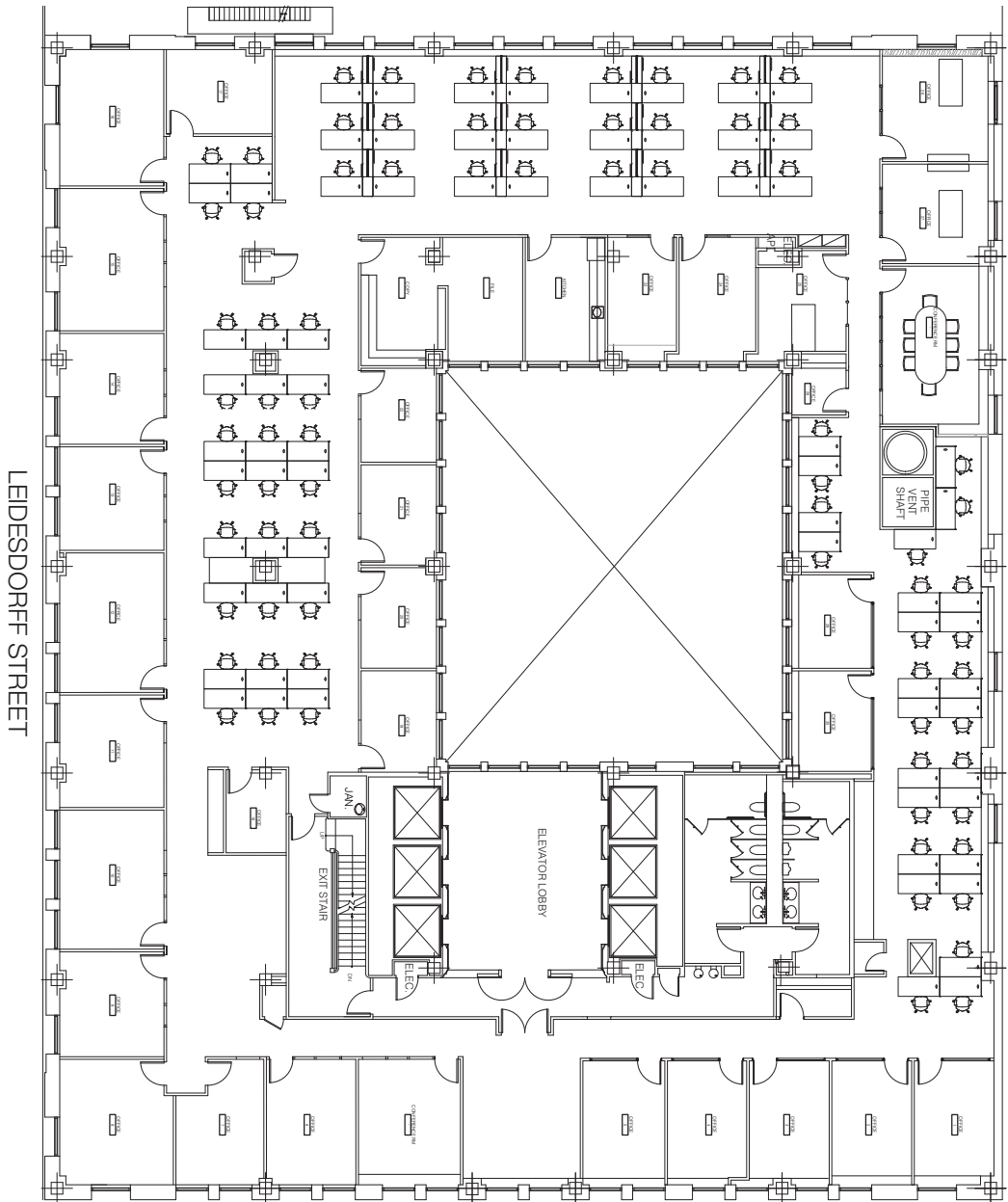

LEIDESDORFF STREET

FLOOR	RSF	COMMENTS
7	15,264 ft. ²	Dramatic full floor premises. Large windows on eight sides provides attractive natural light. Higher than normal drop ceilings provides a nice sense of volume and open space even though there are multiple offices. 30 private offices, two conference rooms, storage and private restrooms. Open areas could accommodate over 70 workstations. Plus all the benefits of the Merchants Exchange Building. The Julia Morgan Ballroom, Merchants Exchange Club and extra conference rooms that can be rented on an hourly basis. With a complete commercial kitchen in the building Landlord can provide full catering breakfast, lunch and dinner including a liquor license for a full bar menu if needed. Available January 1, 2017.

ANDREW THOMPSON

Senior Managing Director
415.445.5112
athompson@newmarkcarey.com
CA RE Lic.# 00987186

**Newmark
Cornish & Carey**

