

**Suite 1300: 17,141 RSF**

- Good North Views
- 20 Private Offices (3 Large Corner Offices and 17 Standard Size)
- 1 Large Boardroom
- 2 Conference Rooms (1 Large)
- Kitchen and Boardroom Pantry
- 2 Copy Rooms
- Large Server Room
- ± 36 Work Stations



**Boardroom**



**Corner Office**

**Greg Hylton**  
CA Lic. #01189288  
greg.hylton@cushwake.com  
415-352-2402

**Margaret R. Duskin**  
CA Lic. #00471868, LEED GA  
mduskin@cushwake.com  
415-773-3538

Cushman & Wakefield of California, Inc.  
Lic. #00616335  
425 Market Street, Suite 2300  
San Francisco, CA 94105  
www.cushmanwakefield.com

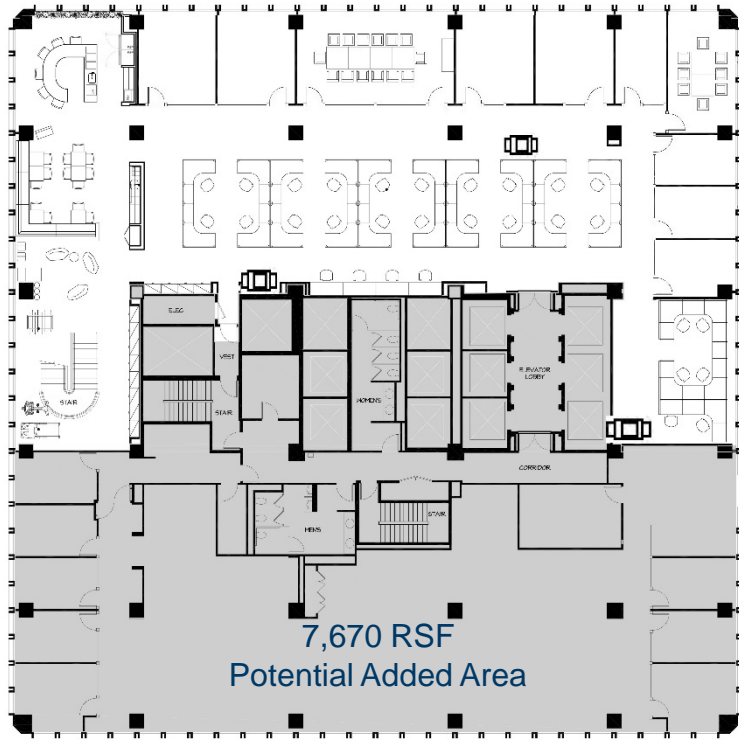

**Suite 1200: 10,171 RSF**

- Kitchen and Large Break Area/Lounge
- 8 Private Offices
- Two Conference Rooms
- ± 26 Work Stations
- Good North Views



Break Area/Lounge



Major Kitchen

**Greg Hylton**  
CA Lic. #01189288  
greg.hylton@cushwake.com  
415-352-2402

**Margaret R. Duskin**  
CA Lic. #00471868, LEED GA  
mduskin@cushwake.com  
415-773-3538

Cushman & Wakefield of California, Inc.  
Lic. #00616335  
425 Market Street, Suite 2300  
San Francisco, CA 94105  
www.cushmanwakefield.com